

DEWALT

DCE089R/G
DW089LR/LG

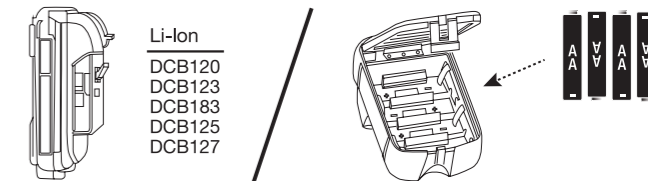

Li-Ion
DCB120
DCB123
DCB183
DCB125
DCB127

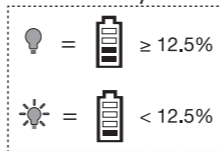
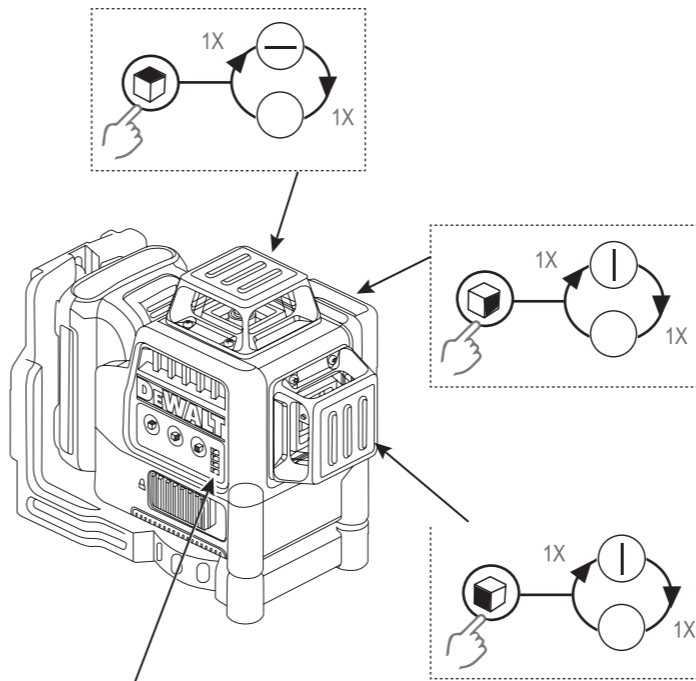
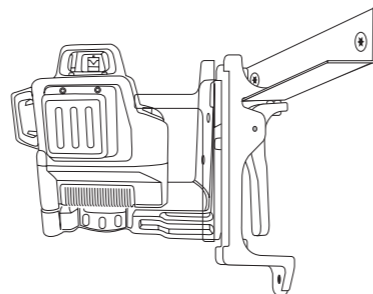
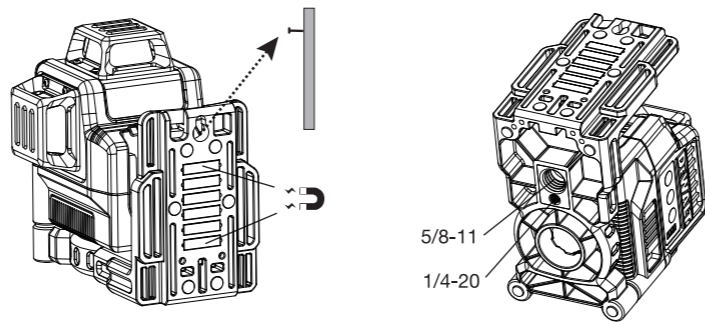
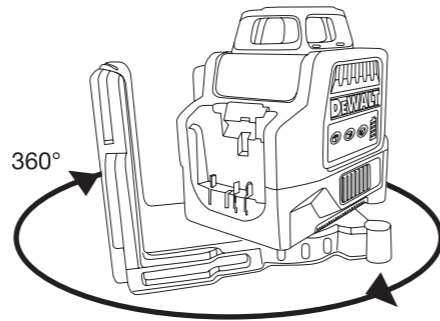
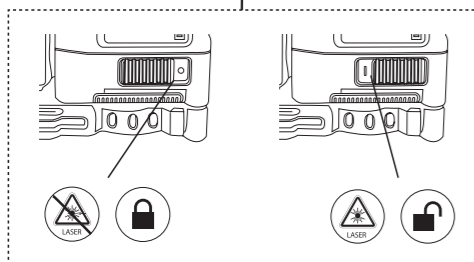
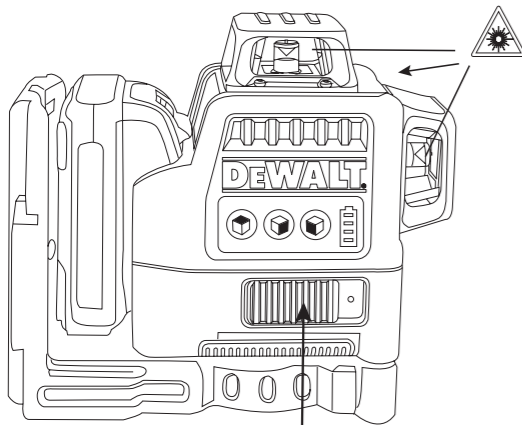
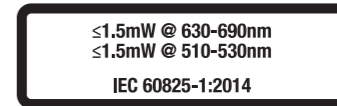
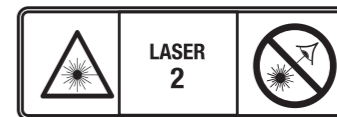
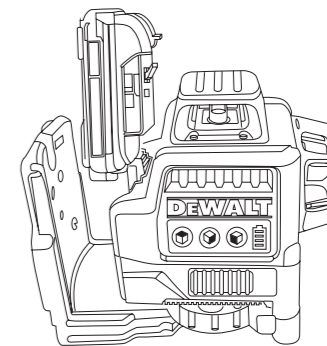

Complies with 21 CFR 1040.10 and 1040.11 except for conformance with IEC 60825-1 Ed. 3, as described in Laser Notice No. 56, dated May 8, 2019

© 2021 DeWALT Industrial Tool Co.
701 East Joppa Road
Towson, Maryland 21286
November 2021
P/N NA127867
www.dewalt.com

© 2021 DeWALT Industrial Tool Co.
DEWALT EU, Black- & Decker-Strasse 40,
D-65510 Idstein, Germany

UK Importer - DeWALT UK, 270 Bath Rd,
Slough SL1 4DX, England
www.2helplu.com



Checking Accuracy ① → ④

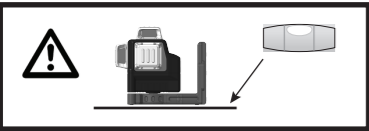

DE Genauigkeitsprüfung
 DK Kontrol af nøjagtighed
 ES Comprobar la precisión
 ES-SA Comprobación de la precisión
 FIN Tarkkuuden tarkistaminen
 FR Vérification de la précision
 FR-CAN Vérification de la précision
 GR Έλεγχος ακρίβειας
 IT Controllo precisione
 NL Nauwkeurigheid controleren
 NO Kontrollere nøyaktighet
 PT Verificar a precisão
 PT-BRA Verificação da Precisão
 SE Kontroll av noggrannhet
 TR Doğruluk Kontrolü

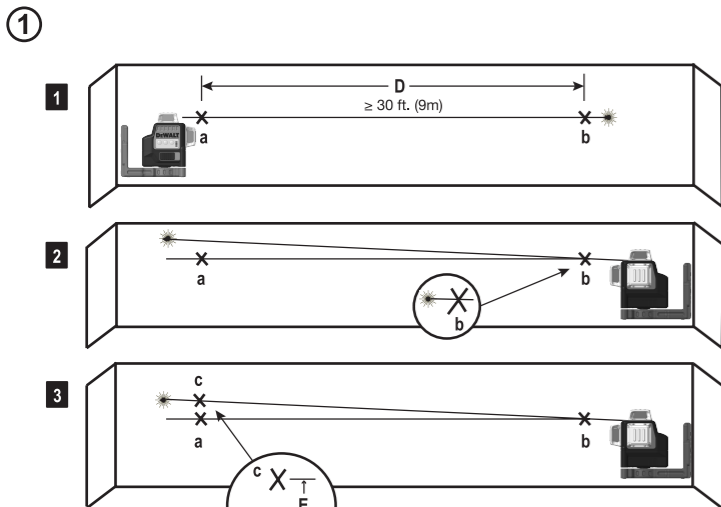

4

| D | E |
|-----------|-----------------|
| 30' (9m) | 1/4" (6.0mm) |
| 40' (12m) | 5/16" (8.0mm) |
| 50' (15m) | 13/32" (10.0mm) |

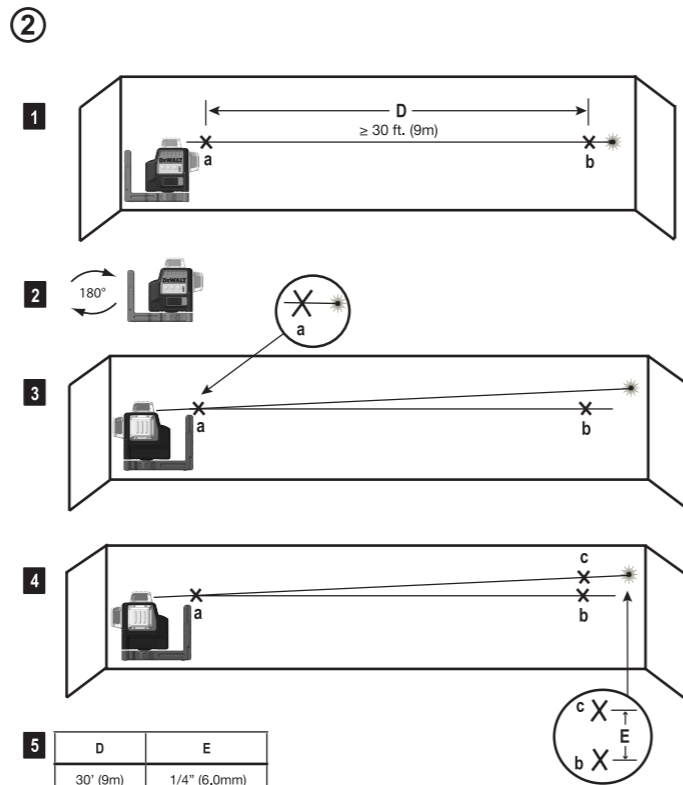

5

| D | E |
|-----------|-----------------|
| 30' (9m) | 1/4" (6.0mm) |
| 40' (12m) | 5/16" (8.0mm) |
| 50' (15m) | 13/32" (10.0mm) |

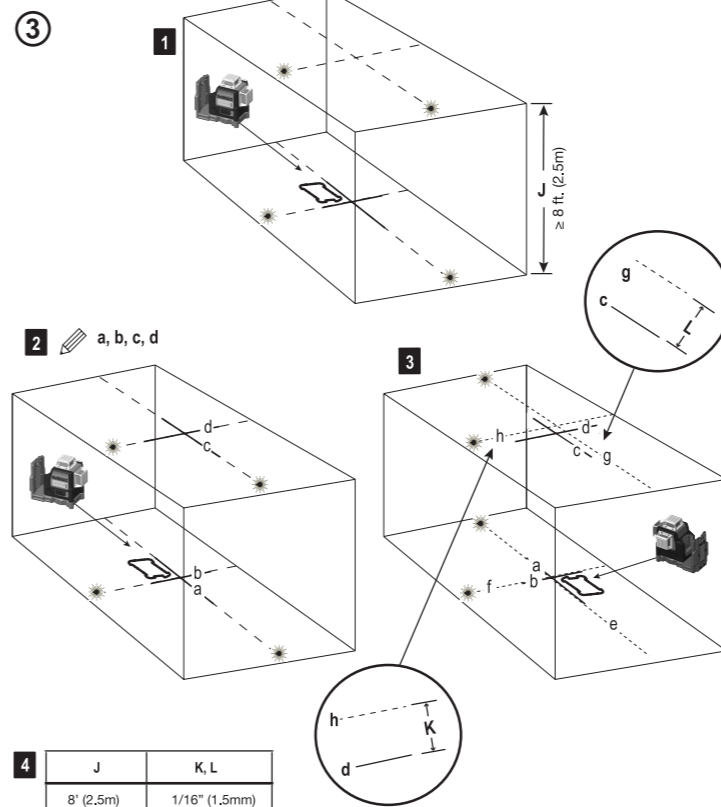

4

| J | K, L |
|-----------|---------------|
| 8' (2.5m) | 1/16" (1.5mm) |
| 10' (3m) | 3/32" (2.0mm) |
| 14' (4m) | 1/8" (2.5mm) |
| 20' (6m) | 5/32" (4mm) |
| 30' (9m) | 1/4" (6mm) |

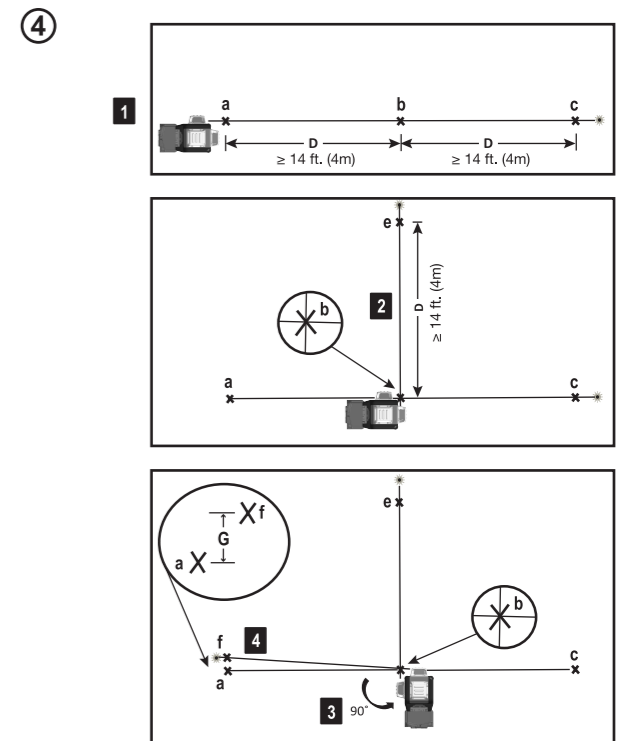

5

| D | G |
|----------|---------------|
| 14' (4m) | 5/32" (3.5mm) |
| 17' (5m) | 3/16" (4.5mm) |
| 20' (6m) | 7/32" (5.5mm) |
| 23' (7m) | 1/4" (6mm) |