

BLACK & DECKER®
BDL500S QUICK REFERENCE GUIDE

ACCU-SPACING (EQUAL SPACING)

- Take a measurement of a wall on which you want to hang equally spaced items as shown in **figure 1**.

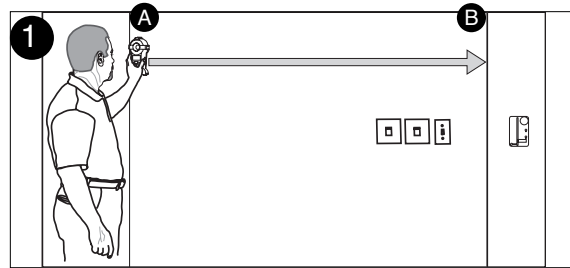

- Press the “**accu-spacing button**”, **figure 2**, once for every item to hang or equally space. 3 items, press the button 3 times up to a total of 20 items.

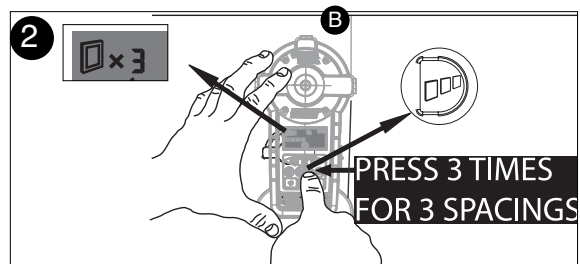

- Roll the unit back toward the start point of the measurement as shown in **figure 3**.

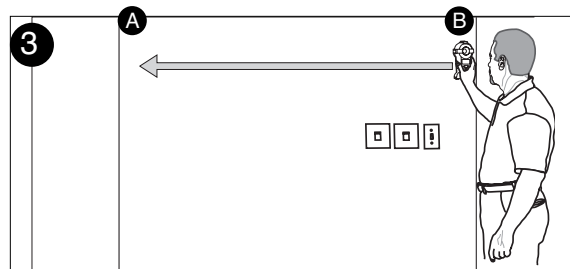

- When the unit gets within about 3 inches of the required spacing point it will beep slowly and it will indicate the direction toward the point with an arrow on the LCD screen.

- The exact location is indicated on the LCD screen as “**1 of 3**”. Mark this point with a pencil through the center hole of the unit as shown in **figure 4**. Continue on and mark “**2 of 3**”, etc.

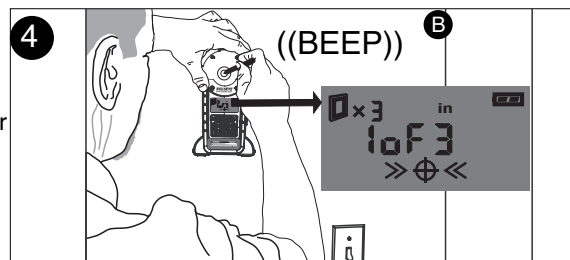

- Figure 5** illustrates a typical application for the laser when it is wall mounted. Refer to the instruction manual for the proper method to hang the laser on a drywall surface.

