

MACHOTM

Instruction Manual
5041 • 5042 • 5043 • 5044 • 5045
Rotary Hammers

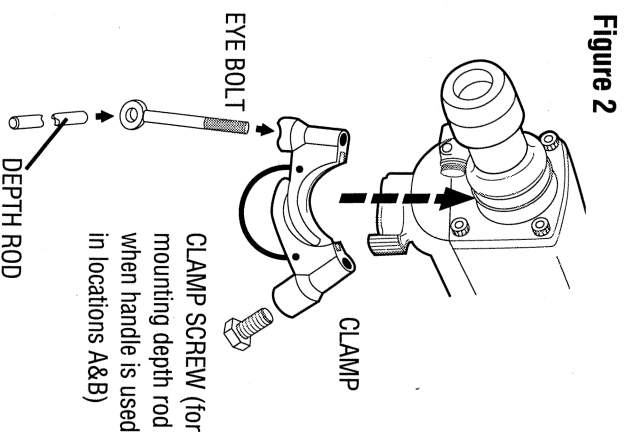

Figure 2

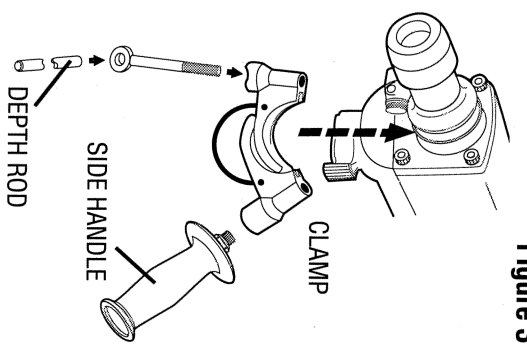

Figure 3

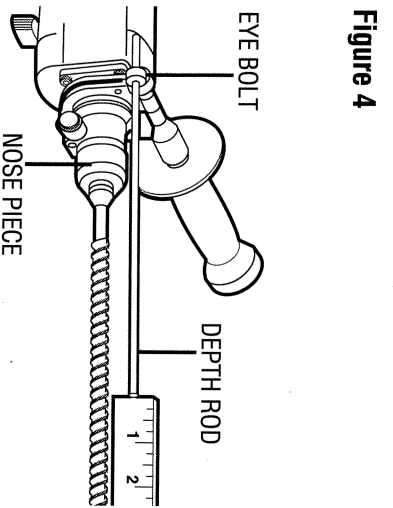

Figure 4

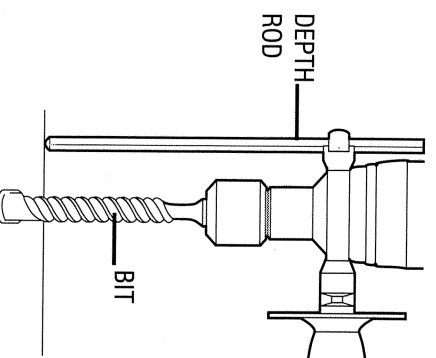

Figure 5

TOOL OPERATION

Switch

To turn the tool ON, depress the trigger switch. Releasing the trigger switch turns the tool OFF.

Inserting Bits and Other Accessories

TURN OFF TOOL AND DISCONNECT FROM POWER SUPPLY.

1. Unlock the tool retainer by pushing it into the tool and holding it.
2. Insert the clean bit shank into the nose piece as far as it will go.
3. Release the tool retainer and it will snap out, automatically locking the bit shank in the nose piece.
4. To remove the bit, push the tool retainer into the tool. Hold it in while you pull the bit shank from the nose piece (wear gloves).

Hammering Action

The type of shank on hammer tools, bits, etc, will determine the type of operation performed by the hammer. Splined shanks inserted directly into the hammer will result in hammering action with rotation. Round shanks will result in hammering action without rotation.

Drilling - Hammering and Rotation

1. When drilling, use just enough force on the hammer to keep it from "bouncing excessively" or "rising" off the bit. Too much force will cause slower drilling speeds and overheating.
2. Drill straight into the masonry, keeping the bit at a right angle to the work. Do not exert side pressure on the bit when drilling as this will cause clogging of the bit flutes and a slower drilling speed.

3. When drilling deep holes, if the hammer speed starts to drop off, pull the bit partially out of the hole with the tool still running to help clear debris from the bit.

4. Only core bits will cut through steel reinforcing rods. A solid carbide percussion bit will walk off the reinforcing rod and probably chip the carbide tip.

5. Do not pour water into the hole to settle dust. Water causes clogging of bit flutes which will tend to make the bit bind in the hole.

Hammering - Without Rotation

Hammer tools such as bull points and chisels may be used with all units except the 5041.

Hammering Only (5043)

INSTALLING SELF-DRILLING ANCHORS

This hammer is recommended for use with self-drilling anchors up to and including 7/8" bolt size. **CAUTION:** We do not recommend using larger size anchors. **TURN OFF TOOL AND DISCONNECT FROM POWER SUPPLY.**

1. Place the proper size chuck on the shank as shown in Figure 6. Insert the shank into the hammer and lock it in place with the tool retainer.

NOTE: Chucks are available from the anchor manufacturer.

2. Place the anchor in the chuck and put the mode indicator in "hammer only" position (Figure 7A).

3. Place the anchor against the concrete and run the hammer until the anchor teeth have penetrated the surface. This will keep the anchor from twisting out of position when you start to drill.

4. **To begin drilling**, put the mode indicator in "Rotate and Hammer" position. (Figure 7B)

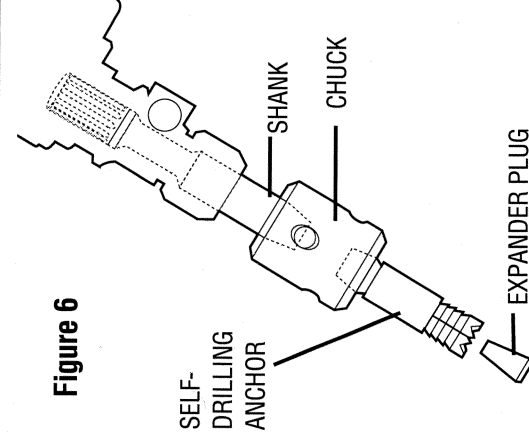

Figure 6

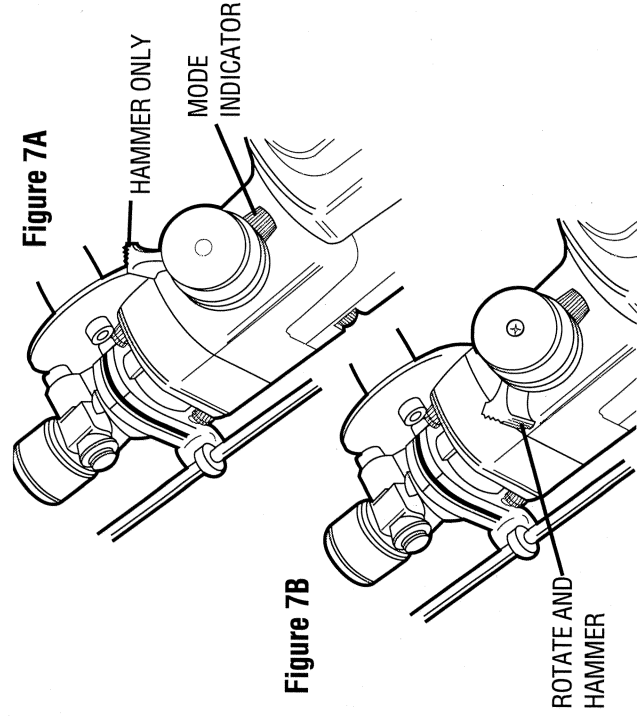
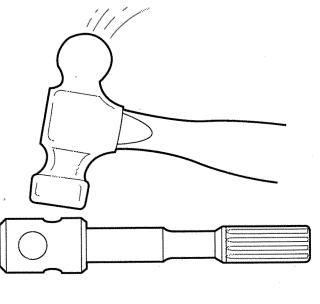

Figure 7A

Figure 7B

5. Drill the anchor into the concrete until the chuck is about 1/8" from the surface of the concrete.

Figure 8



Hand hammer hitting self drilling anchor cone with bit shank attached.

7. **To set the anchor**, place expander plug into end of the anchor and put the mode indicator in "Hammer Only" position. Insert the anchor back into the drilled hole and run the hammer until the anchor has been solidly set.

CAUTION: NEVER SWITCH THE UNIT TO "ROTATE AND HAMMER" MODE AFTER THE ANCHOR HAS BEEN SET.

TURN OFF TOOL AND DISCONNECT FROM POWER SUPPLY BEFORE MAKING ANY ADJUSTMENTS.

Snapping off the anchor: With anchors up to and including 5/8", grasp the hammer handle and pull the tool sharply toward you. This will snap off the cone end of the anchor, which can be removed from the chuck with an ejector wrench. With anchor sizes over 5/8" and up to 7/8", remove the hammer from the shank and snap off the cone with hand hammer. (Figure 8)

Removing the chuck: Insert a drift pin into the hole in the chuck nearest the shank. Hit the drift pin with a hand hammer until the chuck comes off.

TURN OFF TOOL AND DISCONNECT FROM POWER SUPPLY BEFORE SERVICING. Periodically take the following maintenance action:

1. Check the tightness of all external screws, and tighten where necessary.
2. Clean any dirt build-up out of the air slots in the housing.
3. Check the condition of the power supply cord, plug and extension cord. Repair at once if damaged. Always use a 3-prong, grounding type plug if replacement is needed.
4. Your hammer has a maintenance feature called the "B&D CHECKPOINT™" system." When the tool requires motor brush replacement, it will shut down automatically. At this time, the tool should be taken to a B&D service center for cleaning, regreasing and preventive maintenance.
5. If you want to inspect and replace motor brushes yourself, take the following steps:
 - a.) **TURN OFF TOOL AND DISCONNECT FROM POWER SUPPLY.**
 - b.) Remove brush cover screw and brush cover (Figure 9).
 - c.) Remove the brush and field lead screw and lockwasher.
 - d.) Pull out the brush assembly and inspect the brush. If the brush is worn down to the letter or groove on the side of the brush, the brush assembly should be replaced.
 - e.) Reassemble parts as shown in Figure 9.
 - f.) Repeat steps "a-e" for opposite brush.
6. If you replace your own brushes, as soon thereafter as possible, take or send the tool to a B&D service center for cleaning, regreasing, and preventive maintenance.

MAINTENANCE

Figure 9

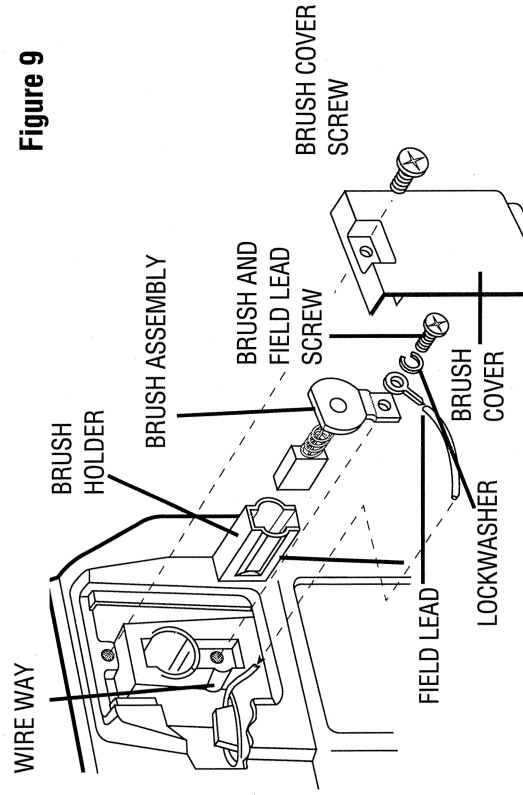

IMPORTANT!

To assure product safety and reliability, particularly for double insulated tools, repairs, maintenance and adjustment (excluding maintenance described in this manual) should be performed by B&D service centers or authorized service centers, using identical B&D replacement parts.

Recommended accessories for use with your tool are available at extra cost from your distributor or your local service center. A complete listing of service centers is included with your tool.

CAUTION: The use of any non-recommended accessory may be hazardous. If you need any assistance in locating any accessory, call 1-800-9-BD TOOL (1-800-923-8665) or contact Black & Decker, Consumer Services Department, 626 Hanover Pike, P.O. Box 618, Hampstead, MD 21074.

Carbide-Tipped Core Bits

Drill up to 2" (5042, 5044) or 3" (5043, 5045) holes through concrete and reinforcing rod with portable hammer. No water or diamond bits necessary.





	For Use With		Body Diameters (in.)
	5042	5043 5044	
X	X	X	1
X	X	X	1 1/8
X	X	X	1 1/4
X	X	X	1 3/8
X	X	X	1 1/2
X	X	X	1 3/4
X	X	X	2
	X	X	2 1/2
	X	X	3

Carbide Percussion Bits

5041	For use with			Bit Dia. (in.)	Usable Drilling Depth (in.)
	5042	5043	5045		
	SPLINE SHANK				
X	X	X	X	3/8	3
X	X	X	X	7/16	6
X	X	X	X	1/2	10
X	X	X	X	9/16	6
X	X	X	X	5/8	6
X	X	X	X	5/8	10
X	X	X	X	5/8	16
X	X	X	X	11/16	6
X	X	X	X	3/4	6
X	X	X	X	3/4	10
X	X	X	X	3/4	16
X	X	X	X	13/16	6
X	X	X	X	7/8	10
X	X	X	X	7/8	16
X	X	X	X	1	10
X	X	X	X	1	16
	X	X	X	1 1/8	6
	X	X	X	1 1/8	16
	X	X	X	1 1/4	10
	X	X	X	1 1/4	16
	X	X	X	1 3/8	10
	X	X	X	1 3/8	16
	X	X	X	1 1/2	10
	X	X	X	1 1/2	16

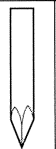
Forged Hammer Tools

(Not recommended for use with 5041)

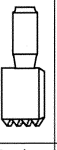
	Hammer Tool	Blade Width (in.)	Length (in.)		Hammer Tool	Blade Width (in.)	Length (in.)
	Bull point for demolition		12 18		Scalloped chisels for removing scale and weld spatter	1 1/4 2	12 12
	Concrete slotting tool for slotting in concrete and breaking "web" between star drill holes to break large openings in walls, etc.	1 1/2	12		Cold chisels for chipping, edging, channelling	7/8 7/8	12 18
	Brushing tool for surfacing concrete				Brushing tool for surfacing concrete		12

Every B&D tool is of the highest quality.

If you wish to contact us regarding this product, please call toll free between 8:00am and 8:00pm ET, seven days a week:

1-800-9-BD TOOL
(1-800-923-8665)

One Year Service/Safety Check

All B&D tools for Industry and Construction are covered under a service/safety check program where B&D will inspect your tool for safety and provide necessary maintenance or repairs, including normal wear and tear parts, for one year, FREE OF CHARGE.

Full Warranty

All B&D tools for Industry and Construction are warranted to be free of any defects in materials or workmanship. Upon thorough examination of tool, B&D will repair or replace, at our option, any product that is determined to be defective.

Conditions

The service/safety check and the warranty do not apply to: repairs made or attempted by anyone other than an authorized B&D service location; misuse, abuse, neglect, improper application of the tool; missing parts; or normal wear and tear (after first year of ownership). Please return the complete unit, transportation prepaid, to any B&D factory owned or B&D authorized service center location (list provided with tool or see Yellow Pages under "Tools Electric").

These symbols on the nameplate mean the product is listed by Underwriter's Laboratories, Inc. and certified by the Canadian Standards Association.



Black & Decker (U.S.) Inc. • 701 East Joppa Road, Towson, Maryland 21286

Printed in U.S.A. (JAN94-CD-1) Form No. 159190 Copyright © 1994